



COMPONENT  
NO. 15806

## **AIRCOOLER CORPORATION**

MFG: WALK-IN COOLER & FREEZER

1751 FLORADALE AVE SOUTH EL MONTE, CA 91733  
626-454-3389

### **SURFACE BURNING CHARACTERISTICS**

FLAME SPREAD

SMOKE DENSITY

LARR# -----

## **WALK-IN INSTALLATION**

### **IMPORTANT:**

Before attempting to install the walk-in, read the instructions carefully. The instructions are enclosed with a shop drawing, which will show each panel in its correct location.

### **PREPARATION OF FLOOR:**

The location of where the walk-in is to be erected must be level to assure proper alignment of panels.

### **FREEZER / COOLER WITHOUT FLOOR:**

Lay out the outside dimensions of the walk-in with a chalk line on the cement floor so that it is squared up. Measure 1/2 the wall thickness and center the key way on this line holding back from corners 6" & width of doorway, put a bead of caulking both sides of key way begin installing the wall panels in the sequence shown on the drawing. After walls are erected install ceiling panels and align with cam-locks and lock together, align ceiling panels with wall panel and lag down.

With 3/8" lag screws, adjust door for proper seal and angle down to cement on inside of walk-in. Insert plug bottoms in cam-lock holes on interior of box.

**NOTE:** (1) When height is not available on top of roof to fasten roof down to walk in, use interior angle.

### **FREEZER / COOLER WITH FLOOR:**

The floor must be leveled from its highest point. A simple way to level the floor is by using shims. It is very important that the floor is level so that the vertical panels will align.

**NOTE:** (2) When locking a panel together and the cam-lock misses the pin it will not lock. Reset the cam-lock by turning it counter-clock wise.

## ATTACHMENT 1

LARR 25747 PAGE 3

## PANEL CONNECTIONS

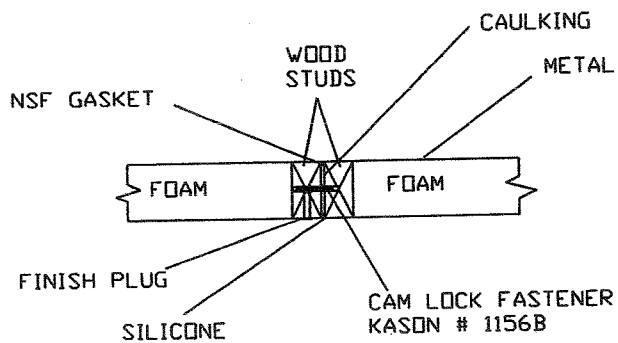
EXTERIORINTERIOR

WALL TO WALL PANEL  
WOOD FRAME

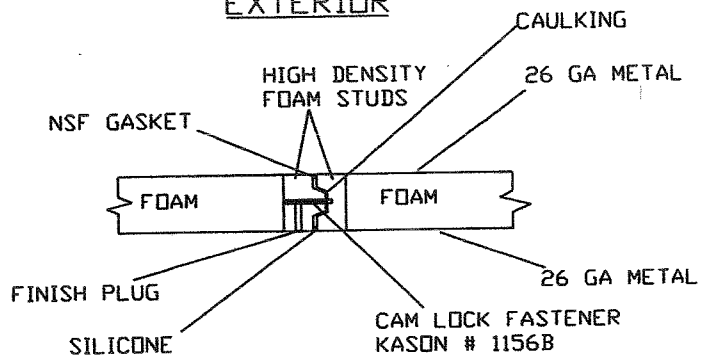
EXTERIORINTERIOR

WALL TO WALL PANEL  
FOAM FRAME

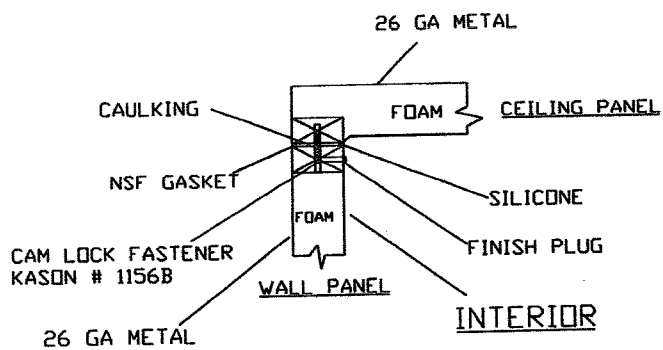
EXTERIOR

CEILING TO WALL PANEL  
CAM LOCK

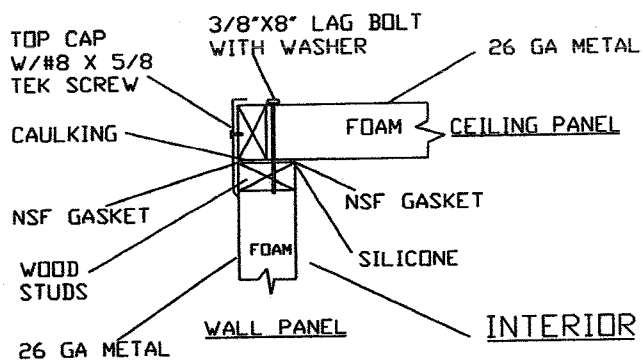
EXTERIOR

CEILING TO WALL PANEL  
LAG SCREW

## ATTACHMENT 2

LARR 25747 PAGE 4

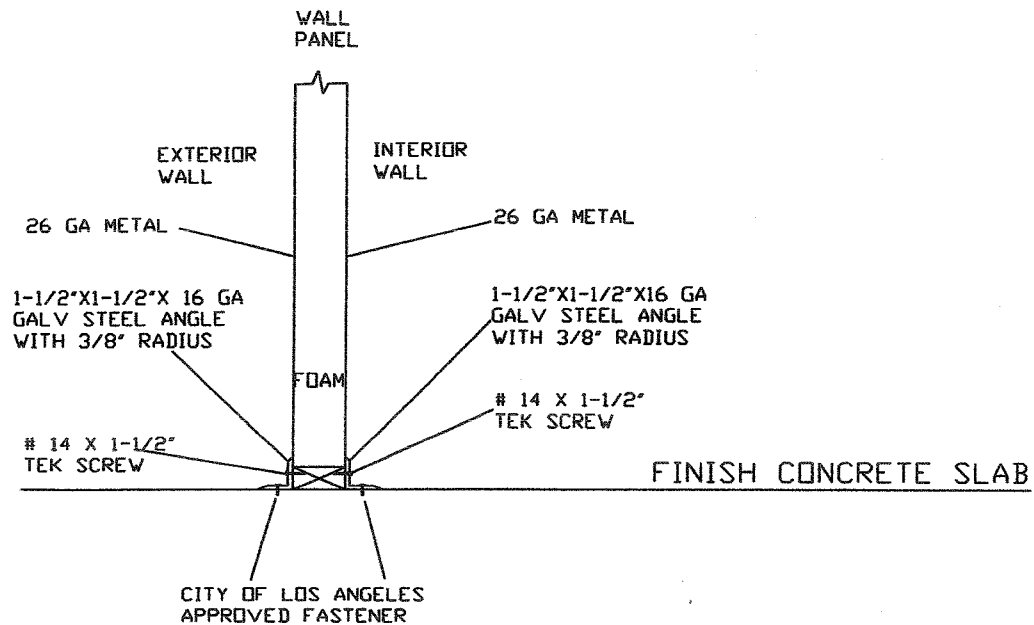
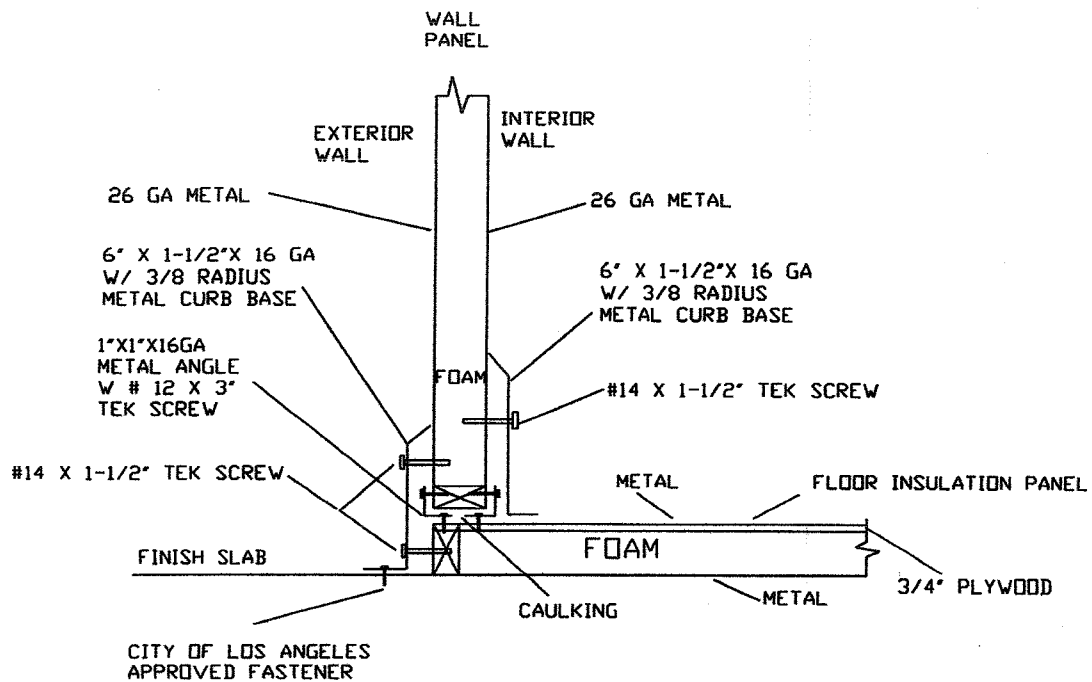
WALL TO FLOOR CONNECTIONSWALL PANEL TO CONCRETE FLOORWALL PANEL TO PRE-FAB FLOOR